

**PLAN OF SURVEY**

**AP143336P**

**LOCATION OF LAND**

**PARISH :** NARBETHONG  
**TOWNSHIP :** NARBETHONG  
**SECTION :** 9  
**CROWN ALLOTMENTS :** 1 to 3 (Parts), 6 to 10  
**SECTION :** 17  
**CROWN ALLOTMENTS :** 1 to 3  
**TITLE REFERENCES :**  
 C/T.'s Vol.8538 Fol.448, Vol.8806 Fol.040,  
 Vol.8806 Fol.041 & Vol.3122 Fol.222  
**LAST PLAN REFERENCES :**  
 Lots 1-6 TP 318945D, Lot 6 TP 446697E,  
 Lot 7 TP 524195W & Lots 1 to 3 TP 348827Q

**NOTATIONS**

The land in the survey is shown enclosed by continuous thick lines. This survey has been connected to Permanent Marks No.'s 6 & 22 in Proclaimed Survey Area No.

**LAND SUBJECT TO EASEMENT**  
NIL

**APPURTANCES**  
NIL

**OTHER NOTATIONS**  
 Depth Limitation: 15.24m for all the land in this plan.  
 Reference marks, occupation features, title connection, kerb and road widths shown are not to scale.

Lot A is applied for subject to the reservations exceptions conditions and powers contained in Crown Grant Vol.3122 Fol.222

**SEE SHEET 2 FOR PLAN.**

Original Sheet Size : A3

**CERTIFICATION BY SURVEYOR**

Sheet 1 of 2

Scale

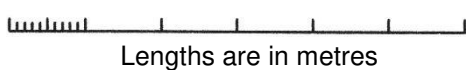

I, Geoff Peter Sutherland of Level 1, 325 Camberwell Road, Camberwell, VIC, 3124 certify that this plan has been prepared from a survey made under my direction and supervision in accordance with the Surveying Act 2004 and completed on 07/12/2018, that this plan is accurate and correctly represents the adopted boundaries and that the survey accuracy accords with that required by regulation 7(1) of the Surveying (Cadastral Surveys) Regulations 2015.

**RODNEY AUJARD & ASSOCIATES**  
*Licensed Land Surveyors*

Level 1, 325 Camberwell Road, CAMBERWELL, 3124.  
 Ph. 9813 2222 Fax 9813 2244  
 81 Grant Street, ALEXANDRA. 3714. Ph. 5772 1530  
 aujard@bigpond.net.au

Surveyors Ref. 19251

Digitally signed by Geoff Peter Sutherland 29/01/2019  
 Licensed Surveyor, Surveying Act 2004

Digitally signed by: Geoff Peter Sutherland, Licensed Surveyor,  
 Surveyor's Plan Version (1),  
 29/01/2019, SPEAR Ref: S135463T

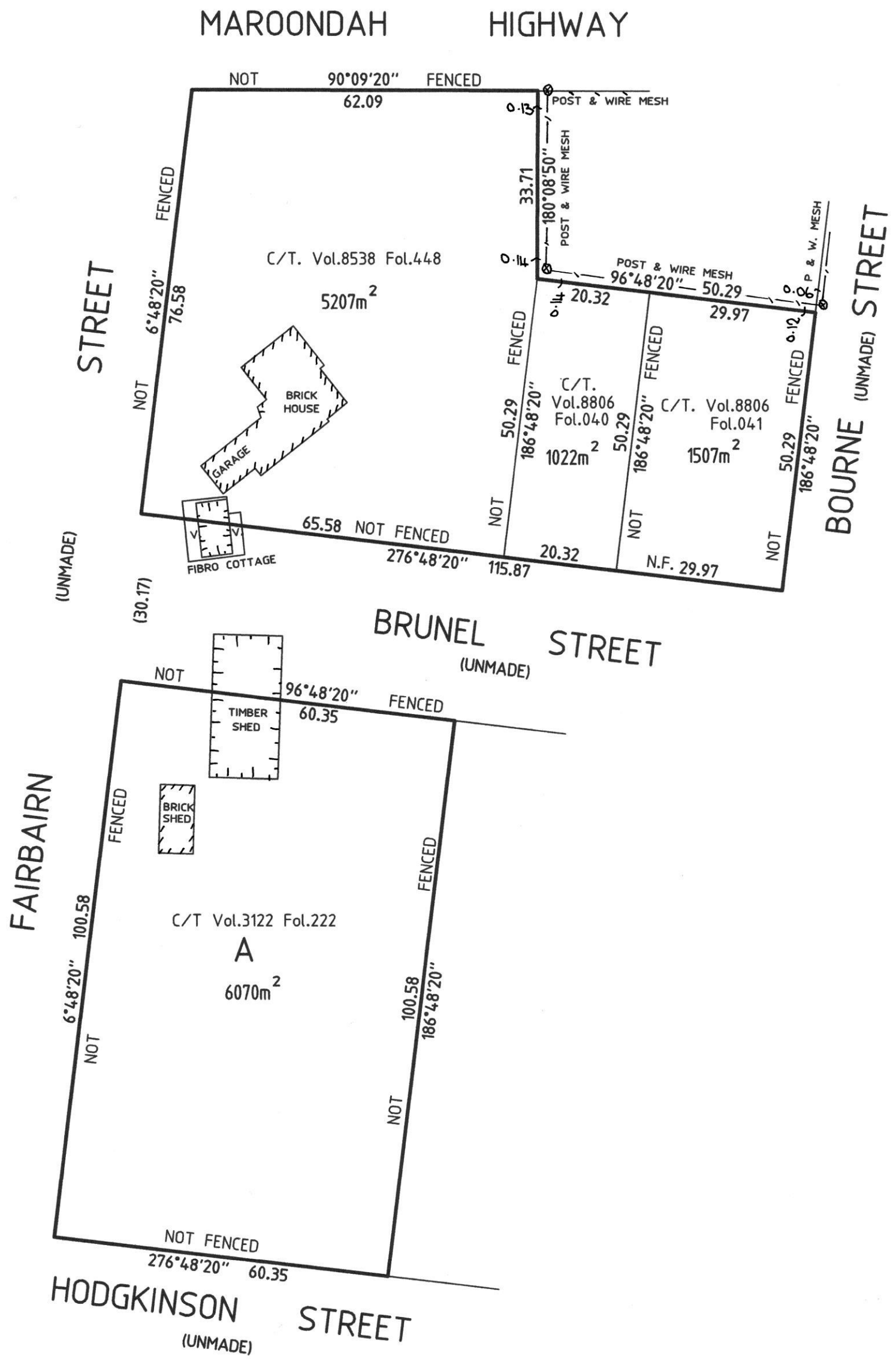

<p><b>RODNEY AUJARD &amp; ASSOCIATES</b> Licensed Land Surveyors Level 1, 325 Camberwell Road, CAMBERWELL, 3124. Ph. 9813 2222 Fax 9813 2244 81 Grant Street, ALEXANDRA. 3714. Ph. 5772 1530 aujard@bigpond.net.au</p>	<p>Scale <b>1:800</b></p> <p>Lengths are in metres</p>	<p>Original Sheet Size : A3</p>	<p>Sheet 2</p>
<p>Surveyors Ref. 19251</p>	<p>Digitally signed by: Geoff Peter Sutherland, Licensed Surveyor, Surveyor's Plan Version (1), 29/01/2019, SPEAR Ref: S135463T</p>		