

Copyright State of Victoria. No part of this publication may be reproduced except as permitted by the Copyright Act 1968 (Cth), to comply with a statutory requirement or pursuant to a written agreement. The information is only valid at the time and in the form obtained from the LANDATA REGD TM System. None of the State of Victoria, its agents or contractors, accepts responsibility for any subsequent publication or reproduction of the information.

The Victorian Government acknowledges the Traditional Owners of Victoria and pays respects to their ongoing connection to their Country, History and Culture. The Victorian Government extends this respect to their Elders, past, present and emerging.

REGISTER SEARCH STATEMENT (Title Search) Transfer of Land Act 1958

VOLUME 11406 FOLIO 779

Security no : 124092568574N
Produced 20/09/2021 12:39 PM

LAND DESCRIPTION

Lot 1 on Plan of Subdivision 704695L.

PARENT TITLES :

Volume 09955 Folio 980 Volume 10968 Folio 345
Created by instrument PS704695L 26/02/2013

REGISTERED PROPRIETOR

Estate Fee Simple
Joint Proprietors

RICHARD LAW
LORNA MARGARET LAW both of 17 VALENTINO DRIVE CROYDON VIC 3136
AK230041T 08/03/2013

ENCUMBRANCES, CAVEATS AND NOTICES

Any encumbrances created by Section 98 Transfer of Land Act 1958 or Section 24 Subdivision Act 1988 and any other encumbrances shown or entered on the plan set out under DIAGRAM LOCATION below.

DIAGRAM LOCATION

SEE PS704695L FOR FURTHER DETAILS AND BOUNDARIES

ACTIVITY IN THE LAST 125 DAYS

NIL

-----END OF REGISTER SEARCH STATEMENT-----

Additional information: (not part of the Register Search Statement)

Street Address: 866 GHIN GHIN ROAD GHIN GHIN VIC 3717

DOCUMENT END

Delivered from the LANDATA® System by InfoTrack Pty Ltd.

The information supplied by Feigl & Newell Pty. Ltd. has been obtained from InfoTrack Pty Limited by agreement between them. The information supplied has been obtained by InfoTrack Pty Limited who is licensed by the State of Victoria to provide this information via LANDATA® System.

Signed by Council: Murrindindi Shire Council, Council Ref: 3/2012/20, Original Certification: 01/10/2012, S.O.C.: 01/10/2012

PLAN OF SUBDIVISION			STAGE No. <hr style="width: 50px; margin: 0 auto;"/>	LRS USE ONLY EDITION 1	PLAN NUMBER PS704695L	
<p style="text-align: center;">LOCATION OF LAND</p> <p>PARISH: GHIN GHIN</p> <p>TOWNSHIP: -</p> <p>SECTION: -</p> <p>CROWN ALLOTMENT: 51, 52 & 53 (PARTS)</p> <p>CROWN PORTION: -</p> <p>TITLE REFERENCES: VOL. 9955 FOL. 980 VOL. 10968 FOL. 345</p> <p>LAST PLAN REFERENCE/S: LOT 1 ON LP 218509L LOT 1 ON PS 545958N</p> <p>POSTAL ADDRESS: 866 GHIN GHIN ROAD (At time of subdivision) GHIN GHIN, 3717</p> <p>MGA Co-ordinates (of approx centre of land in plan) E 357 150 N 5 889 590 ZONE: 55</p>			<p>CERTIFYING AUTHORITY MURRINDINDI SHIRE COUNCIL REF: -</p> <p style="font-size: 1.2em; margin-top: 20px;">THIS IS A SPEAR PLAN</p>			
VESTING OF ROADS AND/OR RESERVES						
IDENTIFIER		COUNCIL/BODY/PERSON				
NIL		NIL				
NOTATIONS						
STAGING THIS IS NOT A STAGED SUBDIVISION Planning permit No. -						
DEPTH LIMITATION DOES NOT APPLY.						
THE DIMENSIONS OF LOT 2 ONLY ARE THE RESULT OF SURVEY						
SURVEY. THIS PLAN IS BASED ON SURVEY THIS SURVEY HAS BEEN CONNECTED TO PERMANENT MARKS No.(s) IN PROCLAIMED SURVEY AREA No.						
EASEMENT INFORMATION					LRS USE ONLY	
LEGEND A – Appurtenant Easement E – Encumbering Easement R – Encumbering Easement (Road)					STATEMENT OF COMPLIANCE/ EXEMPTION STATEMENT	
					RECEIVED <input checked="" type="checkbox"/>	
					DATE 31/01/2013	
					LRS USE ONLY	
					PLAN REGISTERED TIME: 7:18pm DATE: 26/2/2013	
					Roger Mellor Assistant Registrar of Titles	
					SHEET 1 OF 2 SHEETS	
ERIC SALTER PTY. LTD. CONSULTING LAND SURVEYORS 52A, SYDNEY STREET KILMORE 3764 TEL.5782 1414 FAX.5782 2416 125 ROBERTS STREET ESSENDON 3040 TEL.9374 3008			LICENSED SURVEYOR (PRINT) ...ERIC GEORGE SALTER..... SIGNATUREDIGITALLY SIGNED..... DATE REF 9193 VERSION 2 PLAN No.: LAW9193PS.DWG			DATE / / COUNCIL DELEGATE SIGNATURE ORIGINAL SHEET SIZE A3

Plan of Subdivision PS704695L
Concurrent Certification and Statement of Compliance
(Form 3)



SUBDIVISION (PROCEDURES) REGULATIONS 2011

SPEAR Reference Number: S023199B
Plan Number: PS704695L
Responsible Authority Name: Murrindindi Shire Council
Responsible Authority Reference Number 1: 3/2012/20
Surveyor's Plan Version: 2

Certification

This plan is certified under section 6 of the Subdivision Act 1988

Statement of Compliance

This is a statement of compliance issued under section 21 of the Subdivision Act 1988

Public Open Space

A requirement for public open space under section 18 of the Subdivision Act 1988

Has not been made

Digitally signed by Council Delegate: Karen Girvan
Organisation: Murrindindi Shire Council
Date: 01/10/2012

**REGISTER SEARCH STATEMENT (Title Search) Transfer of
Land Act 1958**

VOLUME 11406 FOLIO 780

Security no : 124085519951K
Produced 15/09/2020 04:48 PM

LAND DESCRIPTION

Lot 2 on Plan of Subdivision 704695L.

PARENT TITLES :

Volume 09955 Folio 980 Volume 10968 Folio 345

Created by instrument PS704695L 26/02/2013

REGISTERED PROPRIETOR

Estate Fee Simple

Sole Proprietor

RAYNER GROUP PTY LTD of 5 HENDERSONS ROAD WANDIN NORTH VIC 3139
AS262479Y 17/06/2019

ENCUMBRANCES, CAVEATS AND NOTICES

Any encumbrances created by Section 98 Transfer of Land Act 1958 or Section 24 Subdivision Act 1988 and any other encumbrances shown or entered on the plan set out under DIAGRAM LOCATION below.

DIAGRAM LOCATION

SEE PS704695L FOR FURTHER DETAILS AND BOUNDARIES

ACTIVITY IN THE LAST 125 DAYS

NIL

-----END OF REGISTER SEARCH STATEMENT-----

Additional information: (not part of the Register Search Statement)

Street Address: 181 SWITZERLAND ROAD GHIN GHIN VIC 3717

DOCUMENT END



Imaged Document Cover Sheet

The document following this cover sheet is an imaged document supplied by LANDATA®, Victorian Land Registry Services.

Document Type	Plan
Document Identification	PS704695L
Number of Pages (excluding this cover sheet)	3
Document Assembled	15/09/2020 16:55

Copyright and disclaimer notice:

© State of Victoria. This publication is copyright. No part may be reproduced by any process except in accordance with the provisions of the Copyright Act 1968 (Cth) and for the purposes of Section 32 of the Sale of Land Act 1962 or pursuant to a written agreement. The information is only valid at the time and in the form obtained from the LANDATA® System. None of the State of Victoria, LANDATA®, Victorian Land Registry Services Pty. Ltd. ABN 86 627 986 396 as trustee for the Victorian Land Registry Services Trust ABN 83 206 746 897 accept responsibility for any subsequent release, publication or reproduction of the information.

The document is invalid if this cover sheet is removed or altered.

PLAN OF SUBDIVISION			STAGE No. <hr style="width: 50px; margin: 0 auto;"/>	LRS USE ONLY EDITION 1	PLAN NUMBER PS704695L
<p style="text-align: center;">LOCATION OF LAND</p> <p>PARISH: GHIN GHIN</p> <p>TOWNSHIP: -</p> <p>SECTION: -</p> <p>CROWN ALLOTMENT: 51, 52 & 53 (PARTS)</p> <p>CROWN PORTION: -</p> <p>TITLE REFERENCES: VOL. 9955 FOL. 980 VOL. 10968 FOL. 345</p> <p>LAST PLAN REFERENCE/S: LOT 1 ON LP 218509L LOT 1 ON PS 545958N</p> <p>POSTAL ADDRESS: 866 GHIN GHIN ROAD (At time of subdivision) GHIN GHIN, 3717</p> <p>MGA Co-ordinates (of approx centre of land in plan) E 357 150 ZONE: 55 N 5 889 590</p>			<p>CERTIFYING AUTHORITY MURRINDINDI SHIRE COUNCIL</p> <p>REF: -</p> <p style="font-size: 1.2em; margin-top: 20px;">THIS IS A SPEAR PLAN</p>		
VESTING OF ROADS AND/OR RESERVES					
IDENTIFIER	COUNCIL/BODY/PERSON				
NIL	NIL				
NOTATIONS					
STAGING THIS IS NOT A STAGED SUBDIVISION Planning permit No. -					
DEPTH LIMITATION DOES NOT APPLY.					
<p>THE DIMENSIONS OF LOT 2 ONLY ARE THE RESULT OF SURVEY</p>					
<p>SURVEY. THIS PLAN IS BASED ON SURVEY THIS SURVEY HAS BEEN CONNECTED TO PERMANENT MARKS No.(s) IN PROCLAIMED SURVEY AREA No.</p>					
EASEMENT INFORMATION					LRS USE ONLY
LEGEND A – Appurtenant Easement E – Encumbering Easement R – Encumbering Easement (Road)					STATEMENT OF COMPLIANCE/ EXEMPTION STATEMENT
Easement Reference	Purpose	Width (Metres)	Origin	Land Benefited/In Favour Of	RECEIVED <input checked="" type="checkbox"/>
E-1	ELECTRICITY	5	THIS PLAN SECTION 88 OF THE ELECTRICITY ACT 2000	SPI ELECTRICITY PTY LTD	DATE 31/01/2013
E-1, E-2	CARRIAGEWAY	SEE DIAG.	THIS PLAN	LOT 2 ON THIS PLAN	<p>LRS USE ONLY</p> <p>PLAN REGISTERED TIME: 7:18pm DATE: 26/2/2013</p> <p style="text-align: right;">Roger Mellor Assistant Registrar of Titles</p>
					SHEET 1 OF 2 SHEETS
<p>ERIC SALTER PTY. LTD. CONSULTING LAND SURVEYORS 52A, SYDNEY STREET KILMORE 3764 TEL.5782 1414 FAX.5782 2416 125 ROBERTS STREET ESSENDON 3040 TEL.9374 3008</p>			<p>LICENSED SURVEYOR (PRINT) ...ERIC GEORGE SALTER.....</p> <p>SIGNATURE DIGITALLY SIGNED DATE</p> <p>REF 9193 VERSION 2</p> <p>PLAN No.: LAW9193PS.DWG</p>		<p>DATE / /</p> <p>COUNCIL DELEGATE SIGNATURE</p> <p>ORIGINAL SHEET SIZE A3</p>

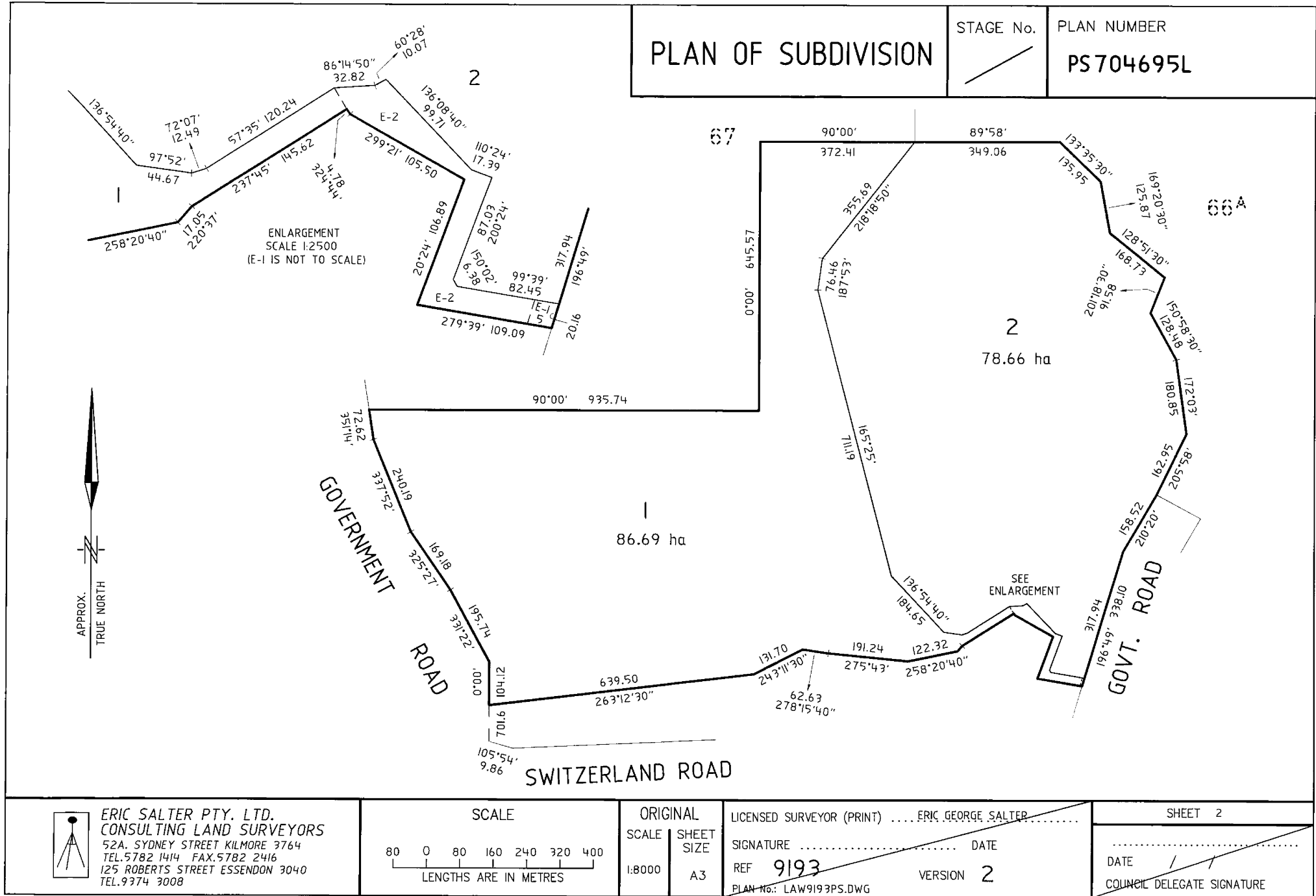

ERIC SALTER PTY. LTD.
CONSULTING LAND SURVEYORS
 52A, SYDNEY STREET KILMORE 3764
 TEL.5782 1414 FAX.5782 2416
 125 ROBERTS STREET ESSENDON 3040
 TEL.9374 3008

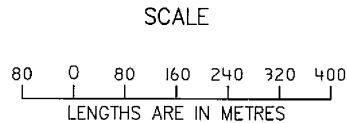

ORIGINAL SCALE 1:8000
 SHEET SIZE A3

LICENSED SURVEYOR (PRINT) ERIC GEORGE SALTER.....
 SIGNATURE DATE
 REF **9193** VERSION **2**
 PLAN No.: LAW9193PS.DWG

SHEET 2
 DATE / /
 COUNCIL DELEGATE SIGNATURE



**Plan of Subdivision PS704695L
Concurrent Certification and Statement of Compliance
(Form 3)**

SUBDIVISION (PROCEDURES) REGULATIONS 2011

SPEAR Reference Number: S023199B
Plan Number: PS704695L
Responsible Authority Name: Murrindindi Shire Council
Responsible Authority Reference Number 1: 3/2012/20
Surveyor's Plan Version: 2

Certification

This plan is certified under section 6 of the Subdivision Act 1988

Statement of Compliance

This is a statement of compliance issued under section 21 of the Subdivision Act 1988

Public Open Space

A requirement for public open space under section 18 of the Subdivision Act 1988

Has not been made

Digitally signed by Council Delegate: Karen Girvan
Organisation: Murrindindi Shire Council
Date: 01/10/2012



Copyright State of Victoria. This publication is copyright. No part may be reproduced by any process except in accordance with the provisions of the Copyright Act 1968 (Cth) and for the purposes of Section 32 of the Sale of Land Act 1962 (Vic) or pursuant to a written agreement. The information is only valid at the time and in the form obtained from the LANDATA REGD TM System. None of the State of Victoria, LANDATA REGD TM System, Victorian Land Registry Services Pty. Ltd. ABN 86 627 986 396 as trustee for the Victorian Land Registry Services Trust ABN 83 206 746 897 accept responsibility for any subsequent release, publication or reproduction of the information.

FINAL SEARCH STATEMENT

Land Use Victoria

Page 1 of 1

Security No : 124085520159J
Produced 15/09/2020 04:55 PM

Volume 11406 Folio 780

ACTIVITY IN THE LAST 125 DAYS

NIL

ADMINISTRATIVE NOTICES

NIL

STATEMENT END